

## \*Feature:

- HALED patent optics design, similar to halogen light effect
- Easy and quick installation
- PF > 0.9, flicker free, follows new ErP
- Dimmable or dim to warm halogen function by triac dimmer
- CRI 95, R9 > 70
- Low UGR
- Peak luminous intensity 1650cd (24°) / 1250cd (36°)
- Metal appearance, excellent heat dissipation
- Lifespan 40000 hrs, 5 years warranty
- High energy efficiency



CE RoHS ErP



## Technical data

Part No.	Type of installation		
CTCA3409WKW/ N/ B	Recessed		
Electrical specifications			
Wattage (W)	9W	Power factor	0.9
AC input voltage (V)	AC200V-240V	Current	43mA
Frequency (Hz)	50/60Hz	DC output voltage (V)	
Flicker metric PST	0.023	Stroboscopic effect metric SVN	0.25
Total harmonic distortion (THD)	24%	Dimmable	Dim to warm
Max. no. of lamps on B16A circuit breaker	280	Max. no. of lamps on C10A circuit breaker	180
Max. no. of lamps on C16A circuit breaker	280		
Photometric specifications			
Color temperature (CCT)	2700K-2100K	CRI/ R9	95/ >70(Min.)
Chromaticity coordinate (x/ y)	2700K: 0.459/ 0.412 2100K: 0.520/ 0.415	Standard deviation of colour	≤5 SDCM
Useful luminous flux (lm)	550lm ± 5%	Luminous efficiency (lm/W)	61lm/ W
UGR	≤19		

## Photometric Information

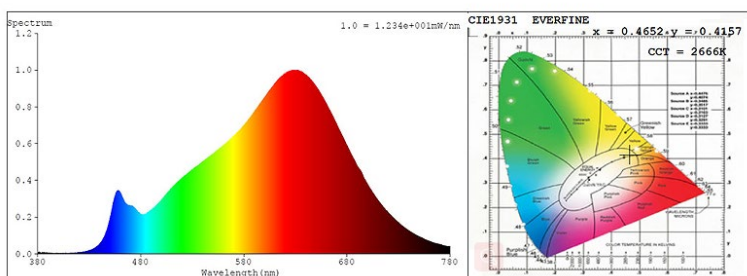

EAN	Colour	Beam angle	Peak Luminous intensity		
41098	Matt White	24°	1650cd		
41103	Stain Nickel	24°	1650cd		
41211	Matt Black	24°	1650cd		
41118	Matt White	36°	1250cd		
41123	Stain Nickel	36°	1250cd		
41206	Matt Black	36°	1250cd		

**Mechanical specifications**

Housing material	Aluminium
Optical cover/ lens material	AlReflector+PC+Glass
Height	55mm
Product weight	200g

**Lifespan**

Number of switching cycles	100,000-
L80/B10 service life at 25°C	40,000 hrs
Warranty	5 Years

**Application parameters**

Working temperatuer range	-20~+50°C
---------------------------	-----------

**Package**

Individual package length	105mm
Individual package height	68mm
Individual package width	105mm
Gross weight (single item)	220g
Driver	Internal

**Housing Colour**

Housing Colour	Matt White / Stain Nickel / Matt Black
Length/ diameter	85mm
Hole size	68mm

**L70/B50 service life at 25°C**

L70/B50 service life at 25°C	50,000 hrs
L90/B10 service life at 25°C	20,000 hrs

**Storage temperature range**

Storage temperature range	-20~+70°C
---------------------------	-----------

**Shipping box height**

Shipping box height	550mm
Shipping box height	166mm
Shipping box width	240mm
Packaging unit	20pcs
Gross weight (Shipping box)	4.8kgs

Technical Drawings (mm)

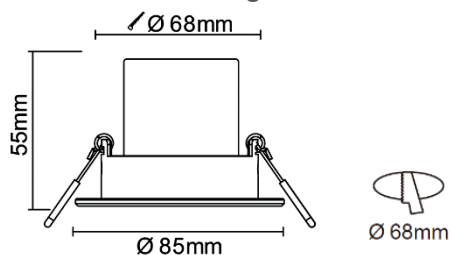

Package



85\*55mm



105\*105\*68mm



550\*20\*166mm(20PCS)

Cautions:

- Power off before replacement
- Do not in violation of any fire regulations when using
- Consult competent electricians for technical support
- If the supply cord is damaged, it shall be exclusively replaced by the manufacture or his service agent o similar qualified person in order to avoid a hazard

Installation /Mounting:

Please read the entire instruction manual before using the product and reserve it for future reference. We reserve the right for any error in text or image and any necessary change made to technical data. If you have any question regarding technical problems, please contact our Customer Services.

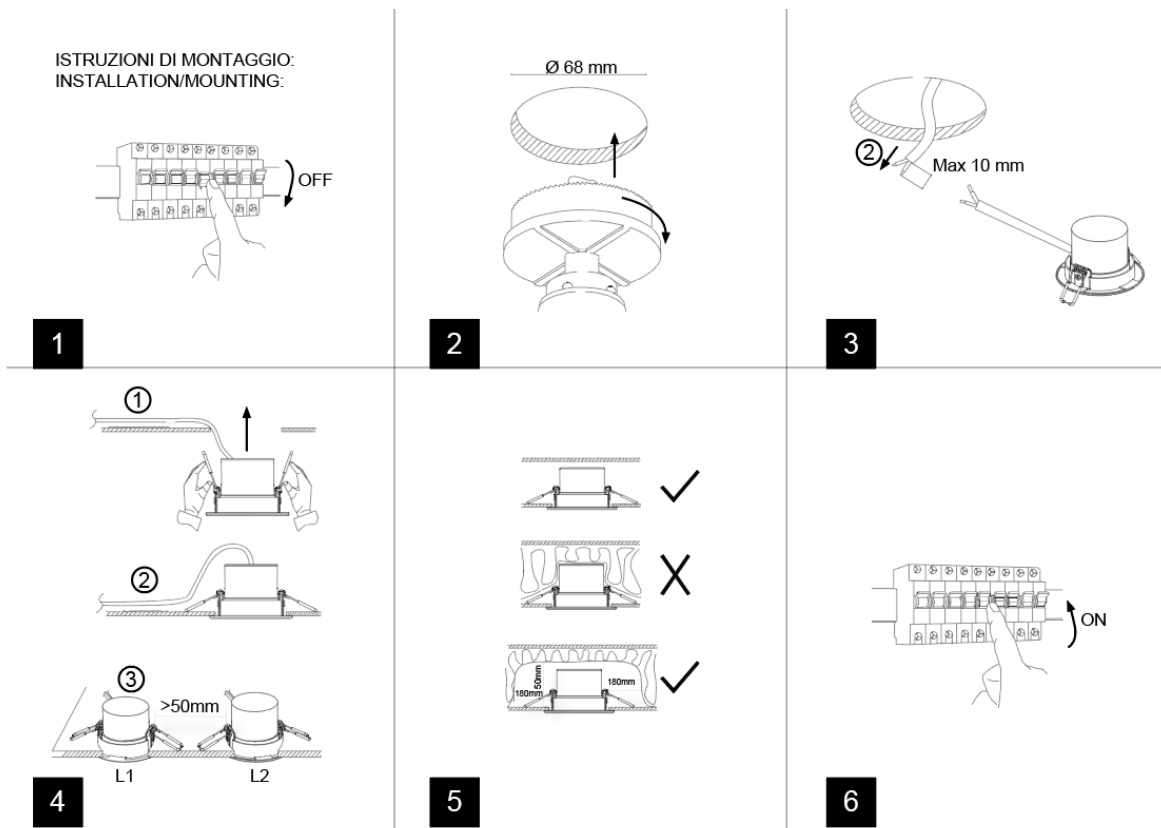

For non replacable lightsources. The light source of this luminaire is not replaceable; when the light source reaches its end of life, the whole luminaire shall be replaced"